



# PROFESSIONAL UNFIRED PRESSURE VESSEL MAKER

## INTRODUCTION

A sending tank, or feed/storage tank, is a vessel used to store and send fluids to industrial processes, including chemical, oil, powder and gas, water treatment, and food and beverage industries. Its primary function is to provide a controlled flow of fluid to other equipment or processes as needed.



**CUSTOMIZED SOLUTION**



**DOSH APPROVED DESIGN**

## SENDING TANK

### NOZZLE DESCRIPTION

- \*N1 - INLET
- \*N2 - INLET
- N3 - INSTRUMENT
- N4 - INSTRUMENT
- \*N5 - OUTLET

**(\*) ~ COMPULSORY NOZZLE**

Please note that every nozzle position is customizable and outlet/spare nozzle can be added on upon request.

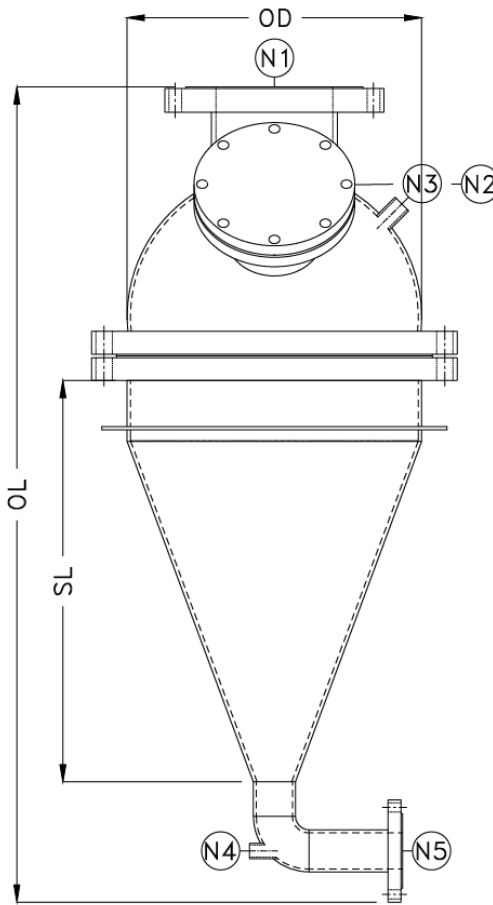

**2D SKETCH**



**3D ILLUSTRATION**

**NOTE**  
OD - OUTSIDE DIAMETER (CUSTOMIZABLE)  
SL - SHELL LENGTH (CUSTOMIZABLE)  
OL - OVERALL LENGTH (CUSTOMIZABLE)

Please note that shell length and shell diameter are both customizable depending on the end user's site requirement.



ENGINEER  DESIGNER  FABRICATOR



# PROFESSIONAL UNFIRED PRESSURE VESSEL MAKER

## SPECIFICATION

### KEY BENEFITS

- **Buffer Storage:** Temporarily store fluids to ensure constant supply during high demand.
- **Prevention of System Overload:** Protect downstream equipment from over-pressurization and excess flow.
- **Energy Efficiency:** Optimize pump operation, reducing energy demand and costs.
- **Improved Process Control:** Balance supply to meet fluctuating fluid demands effectively.

**DESIGN CODE**  
ASME SECTION VIII DIVISION 1  
BS EN 13445

**DESIGN PRESSURE**  
150 PSI / 10 BARG,  
300 PSI / 20 BARG,  
600 PSI / 40 BARG,  
1160 PSI / 80 BARG, or  
customs.

**MATERIAL**  
SA-516 70 (Carbon Steel)  
SA-240 304 (Stainless Steel)  
SA-240 316 (Stainless Steel)

**DESIGN TEMPERATURE**  
100°C / 373.15 K,  
200°C / 473.15 K,  
customs.

### LEGENDS

OD - Outside Diameter  
SL - Shell Length  
OL - Overall Length

MODEL NO.	VOLUME (L)	OD (MM)	SL (MM)	OL (MM)
ST-100	100	457.2	700	< 1500
ST-150	150	457.2	1000	< 1500
ST-200	200	508.0	1000	< 1500
ST-250	250	508.0	1280	< 2000
ST-300	300	558.8	1300	< 2000
ST-350	350	558.8	1310	< 2000
ST-400	400	609.6	1310	< 2000
ST-450	450	609.6	1380	< 2000
ST-500	500	660.4	1450	< 2500
ST-550	550	660.4	1650	< 2500
ST-600	600	660.4	1700	< 2500

## CONTACT

US NOW



+07-288 2287  
(Admin)



admin@acolite.com.my/enquiry  
@acolite.com.my



KAWASAN  
PERINDUSTRIAN  
MAJU JAYA



ENGINEER  DESIGNER  FABRICATOR

*In view of our constant endeavour to improve quality of our products, we reserve the right to alter or change specification without prior notice. All photographs shown in this publication are representative in purpose and to be used for reference purpose only. With this information is given in good faith, no warranty or representation is given concerning such information which must not be taken for establishing any contract or other commitment binding on TESB.*

*\*For actual details and specifications, please refer the TESB offer document.\**